

DRAWING FOR CUSTOMER

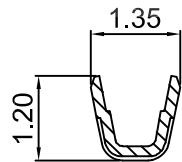

Section B-B

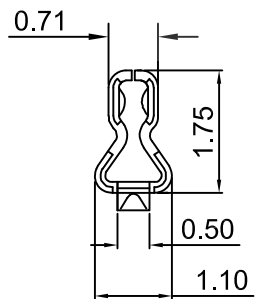
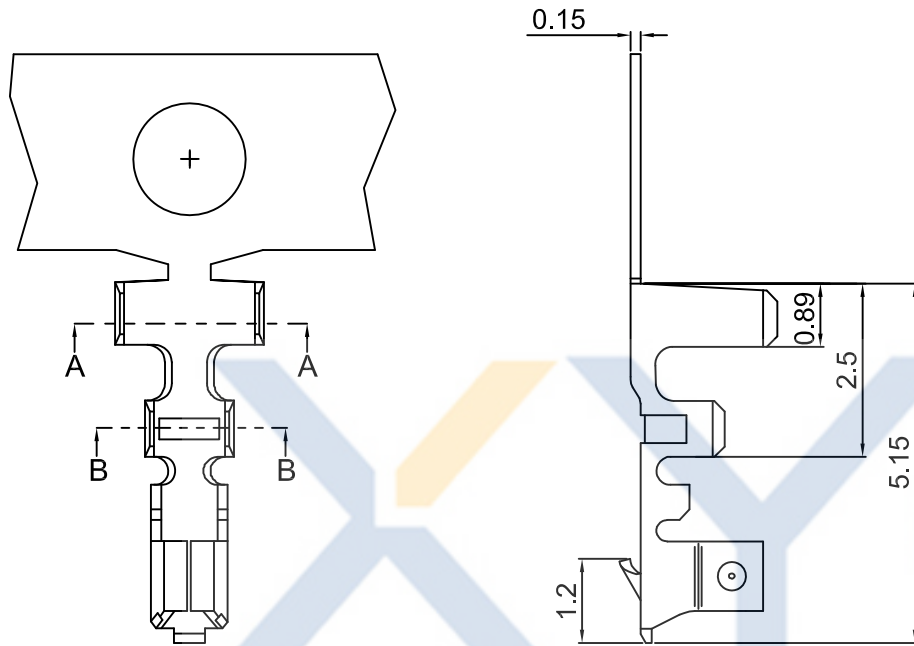
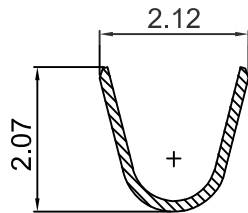

Section A-A

■SPEC.:

- Rated Voltage:50V AC,DC
- Rated Current:1A AC,DC
- Withstand Voltage:500V AC/minute
- Contact Resistance:20mΩ max
- Insulation Resistance:100MΩ min
- Temperature Range:-25℃~+85℃

■Terminal:

- Material:Phosphor Bronze
- Finish:Tin-plated,over
- Applicable wire:AWG#28~32
- QTY.:10KPCS/Reel

KB920-X X T 4 A

- 1:All plated
- 2:Half plated

Plating

- 0: Tin-plat
- 1: Gold Plat1u"
- 2: Gold Plat3u"
- 3: Gold Plat5u"

Version

Mold No.

Terminal

XYCO 东莞市轩业电子科技有限公司
 TEL: 0769-8297 9981/2/3 <http://www.XYCO.com.cn>

2013-09-13	A		KB920-XXT4A	Devin	TOLERANCE 公差	DRAWING 設計者	Devin	KB920-XXT4A	
DATE 日期	VER 版本	CHANGE HISTORY 變更歷史	CHANGED NAME 修改後料號	DRAWING 變更者	.X=±0.30 .XX=±0.20 .XXX=±0.10	CHECKED 審查	Thomas	PART NO. 料號	UNIT 單位
						APPROVED 核准	William	DWG NO. 圖號	mm
1	2	3	4	5	6	7	8	9	PRODUCT NAME 產品名稱

UNIT	mm	PRODUCT NAME	87421 PH1.50mm Wire To Board Terminal
------	----	--------------	---------------------------------------